



GURUGRAM'S  
CROWNING GLORY.  
IN A GREEN OASIS.  
SECTOR 81, GURUGRAM



STERNAL BUILDCON PRIVATE LIMITED | CIN NO.: U70109DL2009PTC195052

REGD. OFF: 13<sup>TH</sup> FLOOR, DR. GOPAL DAS BHAWAN, 28, BARAKHAMBA ROAD, CONNAUGHT PLACE, NEW DELHI - 110001

CORP. OFF.: GROUND FLOOR, TOWER A, SIGNATURE TOWERS, SOUTH CITY 1, GURUGRAM, HARYANA - 122001

Disclaimer :

Disclaimer: Promoter urges every applicant to inspect the project site and shall not merely rely upon any architectural impression, plan or sales brochure and, therefore, requests to make personal judgment prior to submitting an application for allotment. The Project is being developed in phases, hence, certain facilities/amenities etc, may be used by allottee of other phases. Unless otherwise stated, all the images, visuals, materials and information contained herein are purely creative/artistic and may not be actual representations of the product and/or any amenities. Further, the actual design may vary in the fit and finished form, from the one displayed above. Journey time shown, if any, is based upon Google Maps which may vary as per the traffic at a relevant point of time.

\*Rate mentioned above does not include GST and other statutory charges, if applicable. T & C Apply. 1 sq. mt. = 10.7639 sq. ft.















**INDEPENDENT FLOORS FOR THE INDEPENDENT YOU**

**DESIGNED BY PADMA BHUSHAN ARCHITECT HAFEEZ CONTRACTOR.**



**FEATURES OF GREEN HOMES**

At Signature Global, we design our buildings following a set of processes and practices to minimise any negative impact on the climate or nature. This, in turn, ensures efficient use of natural resources without unnecessary wastage. For you, this means reducing the maintenance cost while increasing the sustainability of resources.

|  |  |   |  |  |
|--|--|---|--|--|
| <br>Operational energy saving features | <br>Natural ventilation              | <br>Optimum window to wall ratio (WWR)  | <br>Energy-Efficient walls | <br>Reflective roof        |
| <br>High thermal performance windows  | <br>Water saving features           | <br>Low flow water fixtures (taps, showerheads)  | <br>Low flow water closet | <br>Rain water harvesting |
| <br>Waste water treatment & reuse     | <br>Embodied energy saving features | <br>Low embodied energy materials (walls, floor & roof slab, flooring & window frames) |  |  |

Notes:

1. Third party agency which certifies green buildings.
2. Electricity required to operate lights, fans, appliances, etc.
3. Energy required to extract and manufacture the materials which are used to construct and maintain the building.
4. Lights, fans & appliances, which saves energy, such as LED lights, star rated fans, refrigerator, AC, etc.
5. The list is not exhaustive, and the integration of features, if any, may vary from project to project.
6. Promote cross ventilation within habitable spaces.
7. Percentage of buildings's total glazed area to exterior wall area. 8. Low U-value (thermal transmittance) walling material.

# LOCATION MAP



**HOSPITALS**

- A Aarvy Hospital
- B Medeor Hospital
- C Miracle Apollo Spectra Hospital
- D Arc Multispeciality Hospital

**CONNECTIVITY**

- E Dwarka Expressway
- F Hero Honda Chowk
- G Kherki Daula Toll, NH-8
- H Airport
- I IMT Manesar

**SCHOOLS**

- J DPS School
- K Euro International School
- L Matrikiran High School
- M St. Xavier's High School

**HOTELS**

- N Hyatt Regency
- O ITC Grand Bharat
- P Holiday Inn
- Q Karma Lakelands

**H** INDIRA GANDHI INTERNATIONAL AIRPORT T3



ARAVALLI HILLS

ABOUT 1000 ACRES GREEN BELT

MARUTI FACTORY  
IMT MANESAR

SIGNATUREGLOBAL CITY 92

SIGNATUREGLOBAL CITY 37D

GOLDEN GREENS GOLF COURSE

ITC CLASSIC GOLF & COUNTRY CLUB

TARUDHAN VALLY GOLF RESORT

TOLL PLAZA (DELHI)

FROM FARIDABAD

FROM DELHI

FROM MEHRAULI

FROM DWARKA

NEW DELHI JAIPUR EXPRESSWAY

100M ORBITAL RAIL CORRIDOR

SIGNATUREGLOBAL CITY 81 SECTOR 81 GURUGRAM

135M WIDE ROAD / CORRIDOR

150M DWARKA EXPRESS WAY

150M DWARKA EXPRESS WAY

90M GREATER SOUTHERN PERIPHERAL ROAD (GSPR)

SOUTHERN PERIPHERAL ROAD (SPR)

GOLF COURSE EXTN. ROAD

GOLF COURSE ROAD

HUDA CITY CENTRE

BRISTOL HOTEL

DLF CYBER CITY

DLF PHASE 2

DLF SEZ

RAJIV CHOWK

HERO HONDA CHOWK

PROPOSED CLOVER LEAF FLYOVER

HALDIRAM

TOLL PLAZA

ISBT / METRO DEPOT

CENTRAL PERIPHERY ROAD (CPR)

PATAUDI ROAD

TO PATAUDI

TO KUNDLI / CHANDIGARH

TO JAIPUR

TO PALWAL

KMP EXPRESS WAY

300M WIDE WITH GREEN BELT

SIGNATUREGLOBAL CITY 81 SECTOR 81 GURUGRAM



NH8

NH8

NH8

NATIONAL HIGHWAY 8

MRTS

MRTS

MRTS

MRTS

MRTS

MRTS

MRTS

MRTS

MRTS

MRTS

MRTS

MRTS

MRTS

MRTS

MRTS

MRTS

MRTS

MRTS

MRTS

MRTS

MRTS

MRTS

MRTS

MRTS

MRTS

MRTS

MRTS

MRTS

MRTS

MRTS

MRTS

MRTS

MRTS

MRTS

MRTS

MRTS

MRTS

MRTS

MRTS

MRTS

MRTS

MRTS

MRTS

MRTS

MRTS

MRTS

MRTS

MRTS

MRTS

MRTS

MRTS

MRTS

MRTS

MRTS

MRTS

MRTS

MRTS

MRTS

MRTS

MRTS

MRTS

MRTS

MRTS

MRTS

MRTS

MRTS

MRTS

MRTS

MRTS

MRTS

MRTS

MRTS

MRTS

MRTS

MRTS

MRTS

MRTS

MRTS

MRTS

MRTS

MRTS

MRTS

MRTS

MRTS

MRTS

MRTS

MRTS

MRTS

MRTS

MRTS

MRTS

MRTS

MRTS

MRTS

MRTS

MRTS

MRTS

MRTS

MRTS

MRTS

MRTS

MRTS

MRTS

MRTS

MRTS

MRTS

MRTS

MRTS

MRTS

MRTS

MRTS

MRTS

MRTS

MRTS

MRTS

MRTS

MRTS

MRTS

MRTS

MRTS

MRTS

MRTS

MRTS

MRTS

MRTS

MRTS

MRTS

MRTS

MRTS

MRTS

MRTS

MRTS

MRTS

MRTS

MRTS

MRTS

MRTS

MRTS

MRTS

MRTS

MRTS

MRTS

MRTS

MRTS

MRTS

MRTS

MRTS

MRTS

MRTS

MRTS

MRTS

MRTS

MRTS

MRTS

MRTS

MRTS









**DRIVE TO THE CROWN OF GURUGRAM, IN THE LAP OF NATURE.**



**DESIGNING AN EVERLASTING LOVE STORY.  
BUILDING A RICH HERITAGE OF PRISTINE GLORY.**



**BUILT TO BE A LEGACY OF COMFORT AND OPULENCE.**



**THE MUSIC SPEAKS THE LANGUAGE OF JOY AT THE AMPHITHEATER**







**KIDS CAN HAVE ALL THE FUN AT THE PLAY AREA.**



**AIM, JUMP AND THROW. HONE YOUR SKILLS IN THIS BASKETBALL COURT.**



**REFRESH WITH A REFRESHING DIP AT THE SWIMMING POOL.**



**ENJOY WORLD-CLASS AMENITIES IN A GREEN PARADISE.**





# THE CLUB

# FEATURES OF CLUB



RECEPTION/WAITING AREA



OUTDOOR DINING



DOCTOR'S ROOM



FOYER/LOUNGE



MINI THEATER



LIBRARY

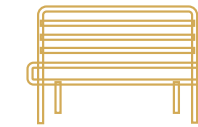

BANQUET HALL



TERRACE PARTY AREA



FINE DINING RESTAURANT



OUTDOOR BANQUET SEATING



FACILITY MANAGER ROOM



LANDSCAPE GREENS FOR YOGA (TERRACE)



CHANGING ROOMS

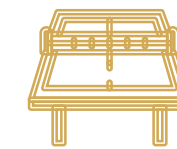
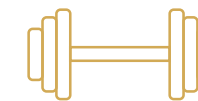

TABLE TENNIS INDOOR GAMES



GYM



SPA / SALON

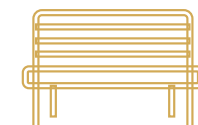

MULTI PURPOSE HALL



KIDS PLAY ROOM





**WORKING FROM HOME NOW GETS MORE CONVENIENT.**



**COMPLEMENT YOUR HOME DÉCOR WITH A TERRACE GARDEN.**



## BLOCK NUMBERING PLAN

| Sr. No. | BLOCK TYPE | PLOT NO. | PLOT TYPE AS PER ZONING | PLOT NO. AS PER ZONING | UNFROZEN |
|---------|------------|----------|-------------------------|------------------------|----------|
| 1       | LILY       | L01      | A                       | A1                     | UNFROZEN |
| 2       | LILY       | L02      | A                       | A2                     | UNFROZEN |
| 3       | LILY       | L03      | A                       | A3                     | UNFROZEN |
| 4       | LILY       | L04      | A                       | A4                     | UNFROZEN |
| 5       | LILY       | L05      | A                       | A5                     | UNFROZEN |
| 6       | LILY       | L06      | A                       | A6                     | UNFROZEN |
| 7       | LILY       | L07      | A                       | A7                     | UNFROZEN |
| 8       | LILY       | L08      | A                       | A8                     | UNFROZEN |
| 9       | LILY       | L09      | A                       | A9                     | UNFROZEN |
| 10      | LILY       | L10      | A                       | A10                    | UNFROZEN |
| 11      | LILY       | L11      | A                       | A11                    | UNFROZEN |
| 12      | LILY       | L12      | M1                      | M1                     | UNFROZEN |
| 13      | LILY       | L13      | A                       | A12                    | UNFROZEN |
| 14      | LILY       | L14      | A                       | A13                    | UNFROZEN |
| 15      | LILY       | L15      | A                       | A14                    | UNFROZEN |
| 16      | LILY       | L16      | A                       | A15                    | UNFROZEN |
| 17      | LILY       | L17      | A                       | A16                    | UNFROZEN |
| 18      | LILY       | L18      | A                       | A17                    | UNFROZEN |
| 19      | LILY       | L19      | A                       | A18                    | UNFROZEN |
| 20      | LILY       | L20      | A                       | A19                    | UNFROZEN |
| 21      | LILY       | L21      | A                       | A20                    | UNFROZEN |
| 22      | LILY       | L22      | A                       | A21                    | UNFROZEN |
| 23      | LILY       | L23      | A                       | A22                    | UNFROZEN |
| 24      | LILY       | L24      | A                       | A23                    | UNFROZEN |
| 25      | LILY       | L25      | A                       | A24                    | UNFROZEN |
| 26      | LILY       | L26      | A                       | A25                    | UNFROZEN |
| 27      | LILY       | L27      | A                       | A26                    | UNFROZEN |
| 28      | LILY       | L28      | A                       | A27                    | UNFROZEN |
| 29      | LILY       | L29      | A                       | A28                    | UNFROZEN |
| 30      | LILY       | L30      | A                       | A29                    | UNFROZEN |
| 31      | LILY       | L31      | A                       | A30                    | UNFROZEN |
| 32      | LILY       | L32      | A                       | A31                    | UNFROZEN |
| 33      | LILY       | L33      | A                       | A32                    | UNFROZEN |
| 34      | LILY       | L34      | A                       | A33                    | UNFROZEN |
| 35      | LILY       | L35      | A                       | A34                    | UNFROZEN |
| 36      | LILY       | L36      | A                       | A35                    | UNFROZEN |
| 37      | LILY       | L37      | A                       | A36                    | UNFROZEN |
| 38      | LILY       | L38      | M3                      | M3                     | UNFROZEN |
| 39      | LILY       | L39      | M4                      | M4                     | UNFROZEN |
| 40      | LILY       | L40      | M5                      | M5                     | UNFROZEN |
| 41      | LILY       | L41      | M6                      | M6                     | UNFROZEN |
| 42      | LILY       | L42      | M7                      | M7                     | UNFROZEN |



| Sr. No. | BLOCK TYPE | PLOT NO. | PLOT TYPE AS PER ZONING | PLOT NO. AS PER ZONING | UNFROZEN |
|---------|------------|----------|-------------------------|------------------------|----------|
| 43      | LILY       | L43      | M2                      | M2                     | UNFROZEN |
| 44      | LILY       | L44      | A                       | A37                    | UNFROZEN |
| 45      | LILY       | L45      | A                       | A38                    | UNFROZEN |
| 46      | LILY       | L46      | A                       | A39                    | UNFROZEN |
| 47      | LILY       | L47      | A                       | A40                    | UNFROZEN |
| 48      | LILY       | L48      | A                       | A41                    | UNFROZEN |
| 49      | LILY       | L49      | A                       | A42                    | UNFROZEN |
| 50      | LILY       | L50      | B                       | B66                    | UNFROZEN |
| 51      | LILY       | L51      | B                       | B67                    | UNFROZEN |
| 52      | LILY       | L52      | B                       | B68                    | UNFROZEN |
| 53      | LILY       | L53      | B                       | B69                    | UNFROZEN |
| 54      | LILY       | L54      | B                       | B70                    | UNFROZEN |
| 55      | LILY       | L55      | B                       | B71                    | UNFROZEN |
| 56      | LILY       | L56      | M8                      | M8                     | UNFROZEN |
| 57      | LILY       | L57      | A                       | A43                    | UNFROZEN |
| 58      | LILY       | L58      | A                       | A44                    | UNFROZEN |
| 59      | LILY       | L59      | A                       | A45                    | UNFROZEN |
| 60      | LILY       | L60      | A                       | A46                    | UNFROZEN |
| 61      | LILY       | L61      | A                       | A47                    | UNFROZEN |
| 62      | LILY       | L62      | A                       | A48                    | UNFROZEN |
| 63      | LILY       | L63      | A                       | A49                    | UNFROZEN |
| 64      | LILY       | L64      | A                       | A50                    | UNFROZEN |
| 65      | LILY       | L65      | A                       | A51                    | UNFROZEN |
| 66      | LILY       | L66      | A                       | A52                    | UNFROZEN |
| 67      | LILY       | L67      | A                       | A53                    | UNFROZEN |
| 68      | LILY       | L68      | A                       | A54                    | UNFROZEN |
| 69      | LILY       | L69      | A                       | A55                    | UNFROZEN |
| 70      | LILY       | L70      | A                       | A56                    | UNFROZEN |
| 71      | LILY       | L71      | A                       | A57                    | UNFROZEN |
| 72      | LILY       | L72      | A                       | A58                    | UNFROZEN |
| 73      | LILY       | L73      | A                       | A59                    | UNFROZEN |
| 74      | LILY       | L74      | A                       | A60                    | UNFROZEN |
| 75      | LILY       | L75      | A                       | A61                    | UNFROZEN |
| 76      | LILY       | L76      | A                       | A62                    | UNFROZEN |
| 77      | LILY       | L77      | M12                     | M12                    | UNFROZEN |
| 78      | LILY       | L78      | M11                     | M11                    | UNFROZEN |
| 79      | LILY       | L79      | M10                     | M10                    | UNFROZEN |
| 80      | LILY       | L80      | M9                      | M9                     | UNFROZEN |
| 81      | LILY       | L81      | A                       | A63                    | UNFROZEN |
| 82      | LILY       | L82      | A                       | A64                    | UNFROZEN |
| 83      | LILY       | L83      | A                       | A65                    | UNFROZEN |
| 84      | LILY       | L84      | A                       | A66                    | UNFROZEN |

| Sr. No. | BLOCK TYPE | PLOT NO. | PLOT TYPE AS PER ZONING | PLOT NO. AS PER ZONING | UNFROZEN |
|---------|------------|----------|-------------------------|------------------------|----------|
| 85      | LILY       | L85      | A                       | A67                    | UNFROZEN |
| 86      | LILY       | L86      | A                       | A68                    | UNFROZEN |
| 87      | LILY       | L87      | A                       | A69                    | UNFROZEN |
| 88      | LILY       | L88      | A                       | A70                    | UNFROZEN |
| 89      | LILY       | L89      | A                       | A71                    | UNFROZEN |
| 90      | LILY       | L90      | A                       | A72                    | UNFROZEN |
| 91      | LILY       | L91      | A                       | A73                    | UNFROZEN |
| 92      | LILY       | L92      | A                       | A74                    | UNFROZEN |
| 93      | LILY       | L93      | A                       | A75                    | UNFROZEN |
| 94      | LILY       | L94      | A                       | A76                    | UNFROZEN |
| 95      | LILY       | L95      | A                       | A77                    | UNFROZEN |
| 96      | LILY       | L96      | A                       | A78                    | UNFROZEN |
| 97      | LILY       | L97      | A                       | A79                    | UNFROZEN |
| 98      | DAFFODILS  | D01      | M24                     | M24                    | UNFROZEN |
| 99      | DAFFODILS  | D02      | B                       | B1                     | UNFROZEN |
| 100     | DAFFODILS  | D03      | B                       | B2                     | UNFROZEN |
| 101     | DAFFODILS  | D04      | B                       | B3                     | UNFROZEN |
| 102     | DAFFODILS  | D05      | B                       | B4                     | UNFROZEN |
| 103     | DAFFODILS  | D06      | B                       | B5                     | UNFROZEN |
| 104     | DAFFODILS  | D07      | B                       | B6                     | UNFROZEN |
| 105     | DAFFODILS  | D08      | B                       | B7                     | UNFROZEN |
| 106     | DAFFODILS  | D09      | B                       | B8                     | UNFROZEN |
| 107     | DAFFODILS  | D10      | B                       | B9                     | UNFROZEN |
| 108     | DAFFODILS  | D11      | B                       | B10                    | UNFROZEN |
| 109     | DAFFODILS  | D12      | B                       | B11                    | UNFROZEN |
| 110     | DAFFODILS  | D13      | B                       | B12                    | UNFROZEN |
| 111     | DAFFODILS  | D14      | C                       | C1                     | UNFROZEN |
| 112     | DAFFODILS  | D15      | C                       | C2                     | UNFROZEN |
| 113     | DAFFODILS  | D16      | C                       | C3                     | UNFROZEN |
| 114     | DAFFODILS  | D17      | C                       | C4                     | UNFROZEN |
| 115     | DAFFODILS  | D18      | C                       | C5                     | UNFROZEN |
| 116     | DAFFODILS  | D19      | C                       | C6                     | UNFROZEN |
| 117     | DAFFODILS  | D20      | C                       | C7                     | UNFROZEN |
| 118     | DAFFODILS  | D21      | C                       | C8                     | UNFROZEN |
| 119     | DAFFODILS  | D22      | C                       | C9                     | UNFROZEN |
| 120     | DAFFODILS  | D23      | C                       | C10                    | UNFROZEN |
| 121     | DAFFODILS  | D24      | C                       | C11                    | UNFROZEN |
| 122     | DAFFODILS  | D25      | C                       | C12                    | UNFROZEN |
| 123     | DAFFODILS  | D26      | C                       | C13                    | UNFROZEN |
| 124     | DAFFODILS  | D27      | C                       | C14                    | UNFROZEN |
| 125     | DAFFODILS  | D28      | C                       | C15                    | UNFROZEN |
| 126     | DAFFODILS  | D29      | C                       | C16                    | UNFROZEN |

| Sr. No. | BLOCK TYPE | PLOT NO. | PLOT TYPE AS PER ZONING | PLOT NO. AS PER ZONING | UNFROZEN |
|---------|------------|----------|-------------------------|------------------------|----------|
| 127     | DAFFODILS  | D30      | C                       | C17                    | UNFROZEN |
| 128     | DAFFODILS  | D31      | C                       | C18                    | UNFROZEN |
| 129     | DAFFODILS  | D32      | B                       | B13                    | UNFROZEN |
| 130     | DAFFODILS  | D33      | B                       | B14                    | UNFROZEN |
| 131     | DAFFODILS  | D34      | B                       | B15                    | UNFROZEN |
| 132     | DAFFODILS  | D35      | B                       | B16                    | UNFROZEN |
| 133     | DAFFODILS  | D36      | B                       | B17                    | UNFROZEN |
| 134     | DAFFODILS  | D37      | B                       | B18                    | UNFROZEN |
| 135     | DAFFODILS  | D38      | B                       | B19                    | UNFROZEN |
| 136     | DAFFODILS  | D39      | B                       | B20                    | UNFROZEN |
| 137     | DAFFODILS  | D40      | B                       | B21                    | UNFROZEN |
| 138     | DAFFODILS  | D41      | B                       | B22                    | UNFROZEN |
| 139     | DAFFODILS  | D42      | B                       | B23                    | UNFROZEN |
| 140     | DAFFODILS  | D43      | B                       | B24                    | UNFROZEN |
| 141     | DAFFODILS  | D44      | B                       | B25                    | UNFROZEN |
| 142     | DAFFODILS  | D45      | B                       | B26                    | UNFROZEN |
| 143     | DAFFODILS  | D46      | B                       | B27                    | UNFROZEN |
| 144     | DAFFODILS  | D47      | B                       | B28                    | UNFROZEN |
| 145     | DAFFODILS  | D48      | B                       | B29                    | UNFROZEN |
| 146     | DAFFODILS  | D49      | B                       | B30                    | UNFROZEN |
| 147     | DAFFODILS  | D50      | B                       | B31                    | UNFROZEN |
| 148     | DAFFODILS  | D51      | B                       | B32                    | UNFROZEN |
| 149     | DAFFODILS  | D52      | B                       | B33                    | UNFROZEN |
| 150     | DAFFODILS  | D53      | B                       | B34                    | UNFROZEN |
| 151     | DAFFODILS  | D54      | B                       | B35                    | UNFROZEN |
| 152     | DAFFODILS  | D55      | B                       | B36                    | UNFROZEN |
| 153     | DAFFODILS  | D56      | B                       | B37                    | UNFROZEN |
| 154     | DAFFODILS  | D57      | B                       | B38                    | UNFROZEN |
| 155     | DAFFODILS  | D58      | B                       | B39                    | UNFROZEN |
| 156     | DAFFODILS  | D59      | B                       | B40                    | UNFROZEN |
| 157     | DAFFODILS  | D60      | B                       | B41                    | UNFROZEN |
| 158     | DAFFODILS  | D61      | B                       | B42                    | UNFROZEN |
| 159     | DAFFODILS  | D62      | B                       | B43                    | UNFROZEN |
| 160     | DAFFODILS  | D63      | B                       | B44                    | UNFROZEN |
| 161     | DAFFODILS  | D64      | M21                     | M21                    | UNFROZEN |
| 162     | DAFFODILS  | D65      | B                       | B45                    | UNFROZEN |
| 163     | DAFFODILS  | D66      | B                       | B46                    | UNFROZEN |
| 164     | DAFFODILS  | D67      | B                       | B47                    | UNFROZEN |
| 165     | DAFFODILS  | D68      | B                       | B48                    | UNFROZEN |
| 166     | DAFFODILS  | D69      | B                       | B49                    | UNFROZEN |
| 167     | DAFFODILS  | D70      | B                       | B50                    | UNFROZEN |
| 168     | DAFFODILS  | D71      | B                       | B51                    | UNFROZEN |

| Sr. No. | BLOCK TYPE | PLOT NO. | PLOT TYPE AS PER ZONING | PLOT NO. AS PER ZONING | UNFROZEN |
|---------|------------|----------|-------------------------|------------------------|----------|
| 169     | DAFFODILS  | D72      | B                       | B52                    | UNFROZEN |
| 170     | DAFFODILS  | D73      | B                       | B53                    | UNFROZEN |
| 171     | DAFFODILS  | D74      | B                       | B54                    | UNFROZEN |
| 172     | DAFFODILS  | D75      | B                       | B55                    | UNFROZEN |
| 173     | DAFFODILS  | D76      | B                       | B56                    | UNFROZEN |
| 174     | DAFFODILS  | D77      | B                       | B57                    | UNFROZEN |
| 175     | DAFFODILS  | D78      | B                       | B58                    | UNFROZEN |
| 176     | DAFFODILS  | D79      | B                       | B59                    | UNFROZEN |
| 177     | DAFFODILS  | D80      | B                       | B60                    | UNFROZEN |
| 178     | DAFFODILS  | D81      | B                       | B61                    | UNFROZEN |
| 179     | DAFFODILS  | D82      | B                       | B62                    | UNFROZEN |
| 180     | DAFFODILS  | D83      | B                       | B63                    | UNFROZEN |
| 181     | DAFFODILS  | D84      | B                       | B64                    | UNFROZEN |
| 182     | DAFFODILS  | D85      | B                       | B65                    | UNFROZEN |
| 183     | DAFFODILS  | D86      | M13                     | M13                    | UNFROZEN |
| 184     | DAFFODILS  | D87      | M14                     | M14                    | UNFROZEN |
| 185     | DAFFODILS  | D88      | M15                     | M15                    | UNFROZEN |
| 186     | DAFFODILS  | D89      | M16                     | M16                    | UNFROZEN |
| 187     | DAFFODILS  | D90      | M17                     | M17                    | UNFROZEN |
| 188     | DAFFODILS  | D91      | M18                     | M18                    | UNFROZEN |
| 189     | DAFFODILS  | D92      | M19                     | M19                    | UNFROZEN |
| 190     | DAFFODILS  | D93      | M23                     | M23                    | UNFROZEN |
| 191     | DAFFODILS  | D94      | M22                     | M22                    | UNFROZEN |
| 192     | DAFFODILS  | D95      | A                       | A80                    | UNFROZEN |
| 193     | DAFFODILS  | D96      | A                       | A81                    | UNFROZEN |
| 194     | DAFFODILS  | D97      | A                       | A82                    | UNFROZEN |
| 195     | DAFFODILS  | D98      | A                       | A83                    | UNFROZEN |
| 196     | DAFFODILS  | D99      | A                       | A84                    | UNFROZEN |
| 197     | DAFFODILS  | D100     | A                       | A85                    | UNFROZEN |
| 198     | DAFFODILS  | D101     | A                       | A86                    | UNFROZEN |
| 199     | DAFFODILS  | D102     | A                       | A87                    | UNFROZEN |
| 200     | DAFFODILS  | D103     | A                       | A88                    | UNFROZEN |
| 201     | DAFFODILS  | D104     | A                       | A89                    | UNFROZEN |
| 202     | DAFFODILS  | D105     | A                       | A90                    | UNFROZEN |
| 203     | DAFFODILS  | D106     | A                       | A91                    | UNFROZEN |
| 204     | DAFFODILS  | D107     | A                       | A92                    | UNFROZEN |
| 205     | DAFFODILS  | D108     | A                       | A93                    | UNFROZEN |
| 206     | DAFFODILS  | D109     | A                       | A94                    | UNFROZEN |
| 207     | DAFFODILS  | D110     | A                       | A95                    | UNFROZEN |
| 208     | DAFFODILS  | D111     | A                       | A96                    | UNFROZEN |
| 209     | DAFFODILS  | D112     | M20                     | M29                    | UNFROZEN |



# SITE PLAN



## AMENITIES

- |  |                            |                            |                       |                     |
|--|----------------------------|----------------------------|-----------------------|---------------------|
| 01. CIRCULAR LANDSCAPE FEATURE WITH PROJECT BRANDING | 07. KID'S PLAY AREA        | 13. MULTIPURPOSE COURT     | 19. MULTIPURPOSE LAWN | 25. TRELIS SEATING  |
| 02. WATER FEATURE                                    | 08. TODDLER'S PLAY AREA    | 14. HALF BASKET BALL COURT | 20. STROLLING PATH    | 26. SKATING RINK    |
| 03. ADULT'S SWIMMING POOL-2                          | 09. OUTDOOR GYM            | 15. BOX CRICKET            | 21. FRAGRANCE GARDEN  | 27. LAWN TENNIS     |
| 04. JACUZZI  | 10. STEPPING STONE PATHWAY | 16. SENIOR CITIZEN AREA    | 22. BUTTERFLY GARDEN  | 28. BADMINTON COURT |
| 05. KID'S SWIMMING POOL-2                            | 11. AMPHITHEATRE           | 17. READING CORNER         | 23. ORCHARD           | 29. SEATING         |
| 06. POOL SIDE DECK-2                                 | 12. YOGA/ MEDITATION LAWN  | 18. JOGGING TRACK          | 24. VEGETABLE GARDEN  | 30. THE CLUB        |
|  |                            |                            |                       | 31. SWIMMING POOL   |



# TYPE-A (3BHK + 2 TOILET)

## UNIT PLAN



## STILT FLOOR PLAN

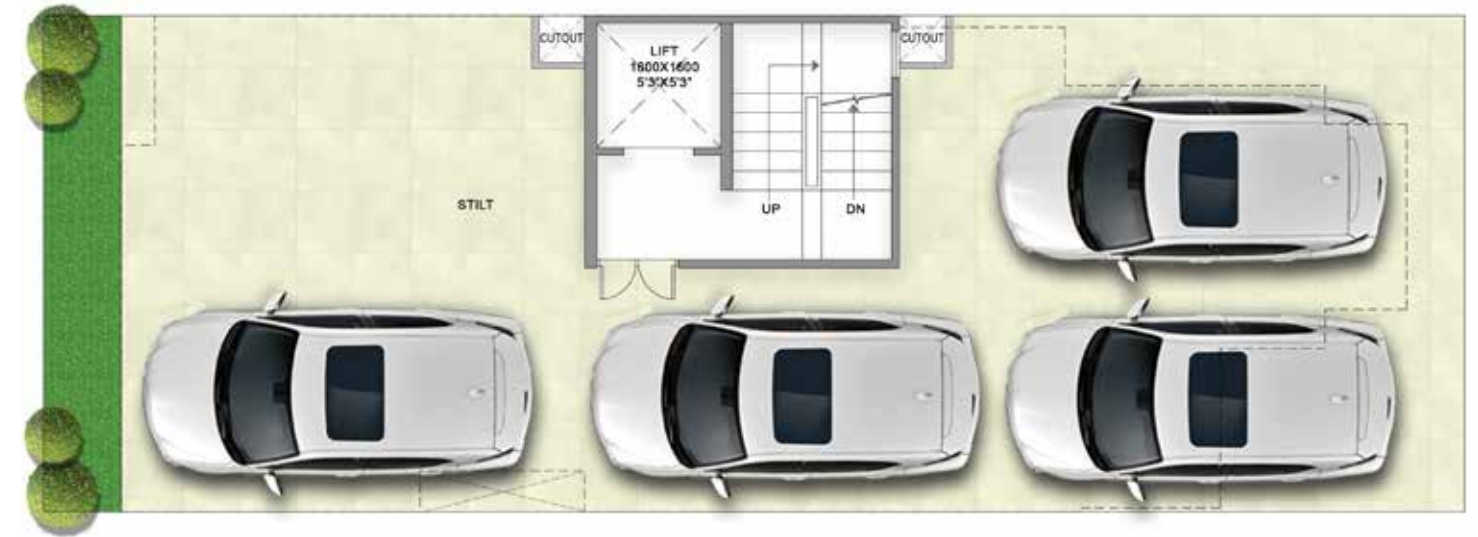

## BASEMENT PLAN



## TERRACE PLAN





# TYPE-B (2BHK + 2 TOILET)

## UNIT PLAN

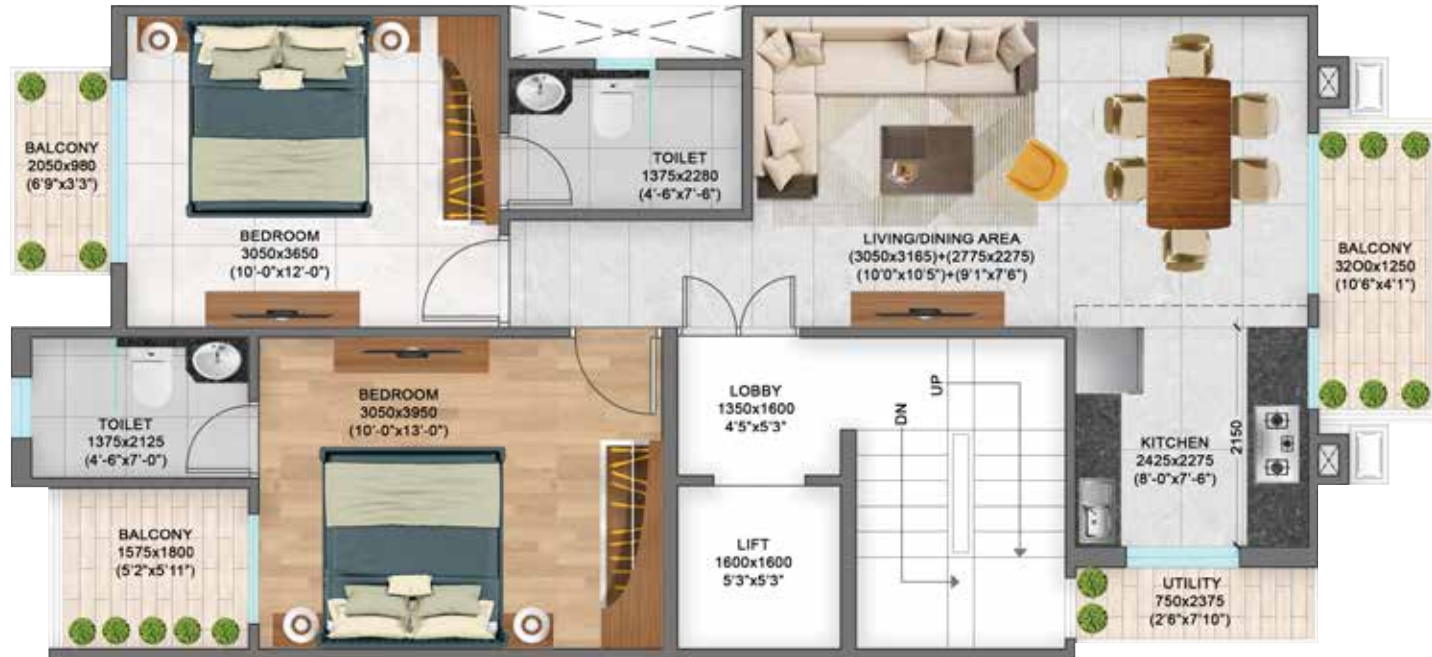

## STILT FLOOR PLAN

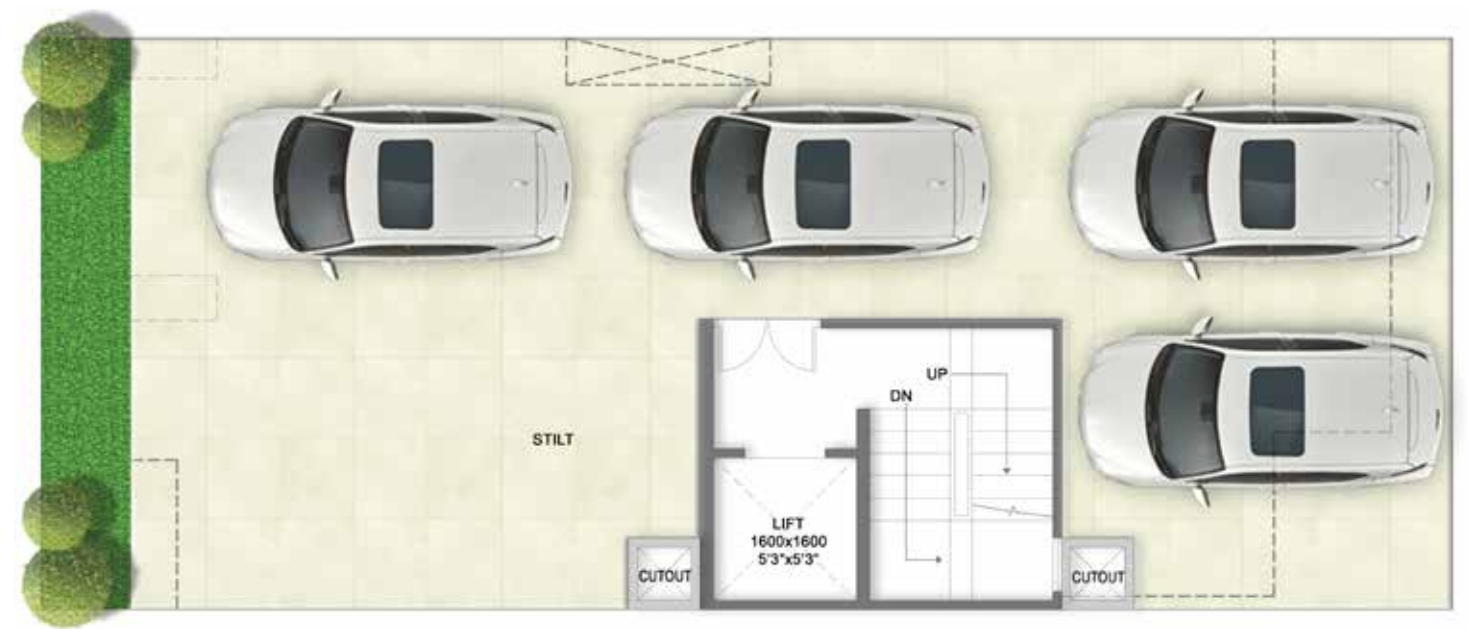

## BASEMENT PLAN



## TERRACE PLAN

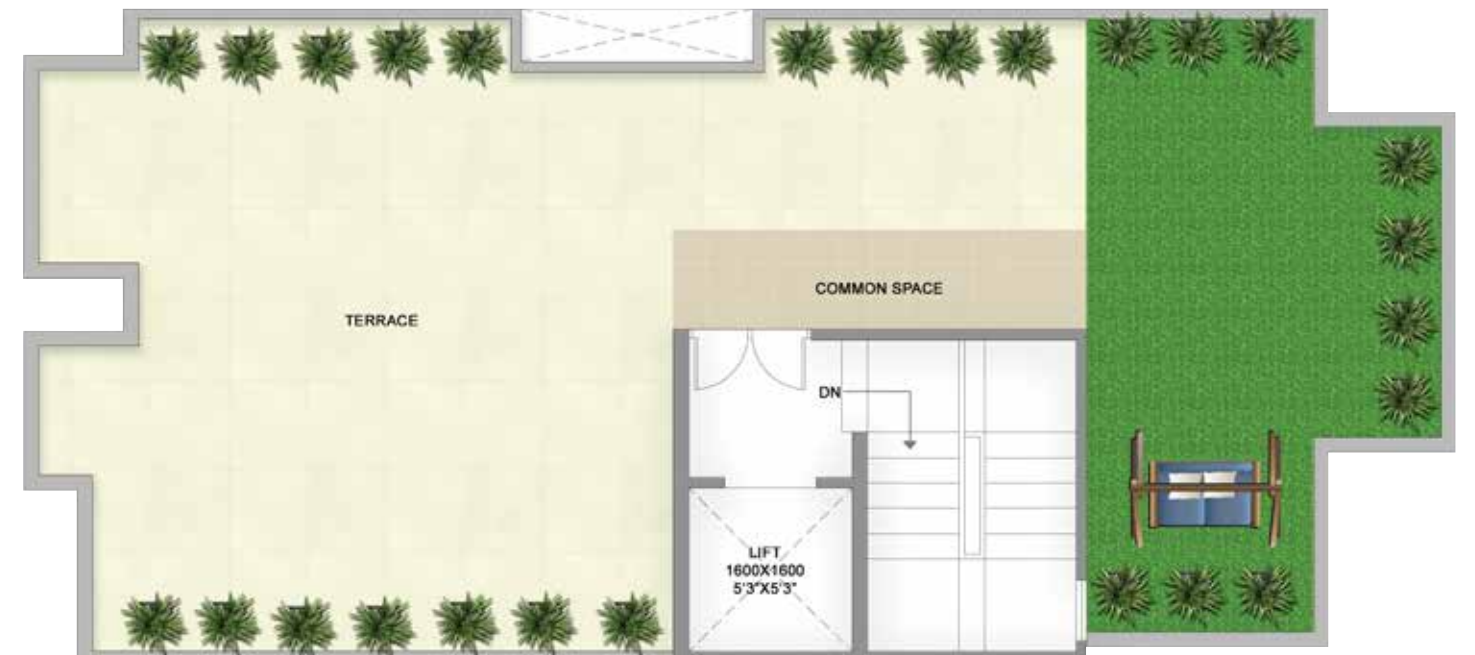



# TYPE-C (3BHK + 2 TOILET)

## UNIT PLAN



## STILT FLOOR PLAN

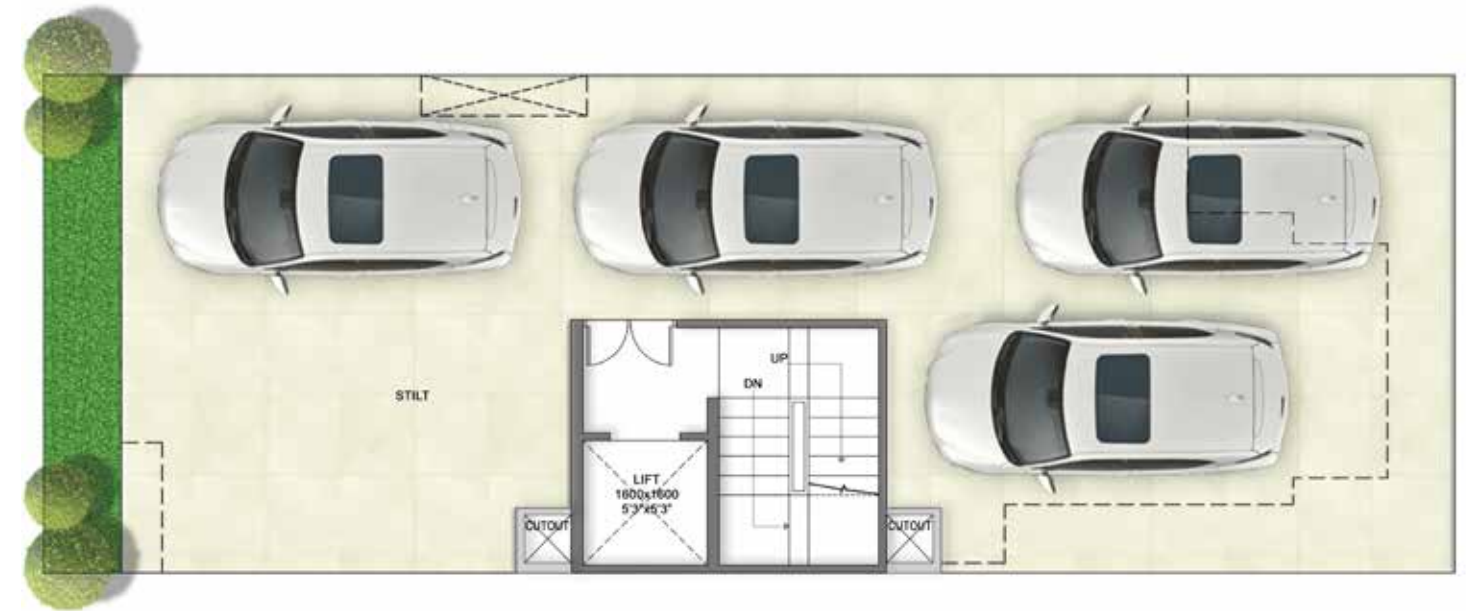

## BASEMENT PLAN



## TERRACE PLAN

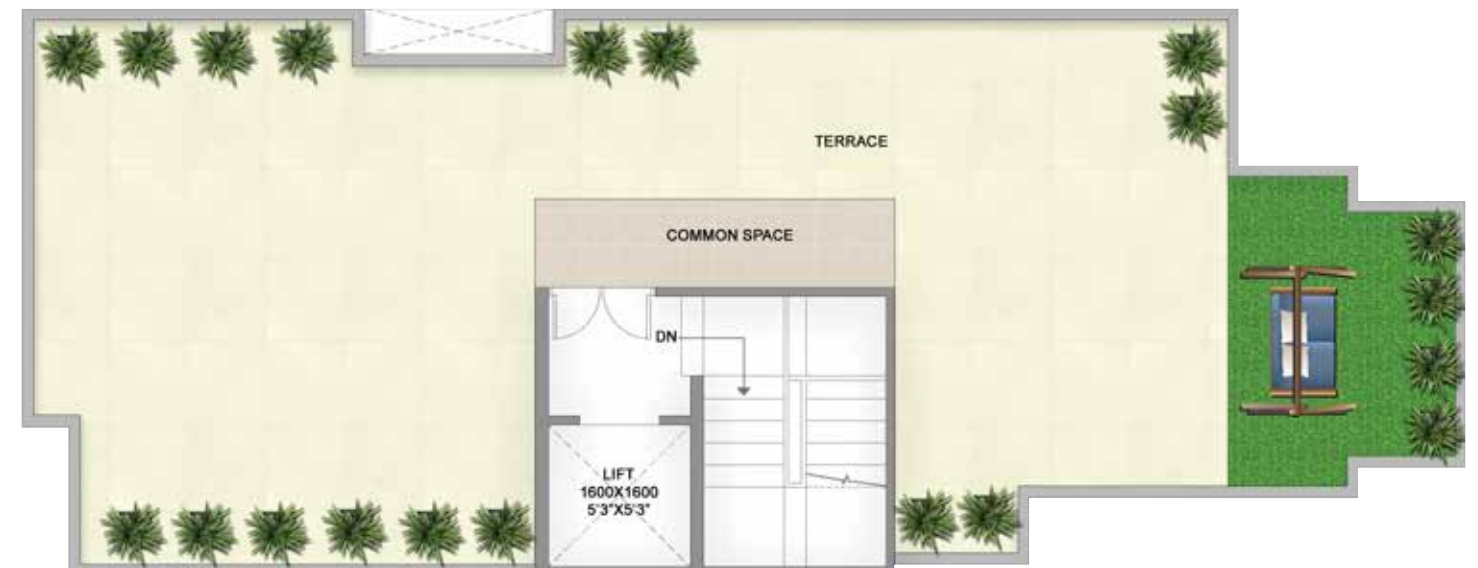



# SPECIFICATIONS

## DRAWING / DINING ROOM



**FLOOR**  
VITRIFIED TILES



**CEILING**  
OIL BOUND DISTEMPER



**WALL**  
ACRYLIC EMULSION

## BALCONIES



**FLOOR**  
ANTI-SKID / MATT  
FINISH CERAMIC TILES



**RAILING**  
WROUGHT IRON RAILING

## BEDROOM

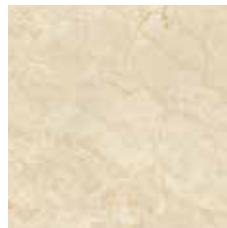

**FLOOR**  
VITRIFIED TILES



**CEILING**  
OIL BOUND DISTEMPER

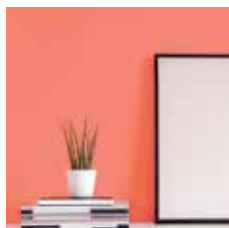

**WALL**  
ACRYLIC EMULSION

## TERRACE



BRICKBAT COBA OR  
WATER PROOFING TREATMENT

## KITCHEN



**FLOOR**  
VITRIFIED /  
CERAMIC TILES



**WALL / CEILING**  
OIL BOUND DISTEMPER



**DADO**  
CERAMIC TILES 600 MM  
ABOVE THE COUNTER



**COUNTER TOP**  
GRANITE STONE



**FITTINGS & FIXTURES**  
ISI MARKED CP FITTINGS  
& SS SINK

## TOILET & BATH



**FLOOR**  
ANTI-SKID  
CERAMIC TILES



**WALL**  
CERAMIC TILES TILL  
7'-0" FEET

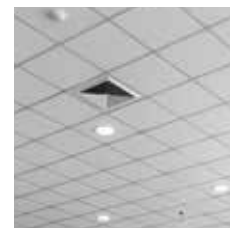

**CEILING**  
GRID FALSE CEILING



**FITTINGS & FIXTURES** ISI MARKED  
CP FITTINGS, WC & WASHBASIN

Note : Flooring in mix design of marble, granite and tile. Accordingly, variations in shade and/ or size and/ or colour and/ or design of the tiles, motifs, mica etc. may occur.

## DOORS & WINDOWS



**MAIN / INTERNAL DOOR FRAME**  
HARD WOOD / RED MERANTI



**INTERNAL DOOR SHUTTERS**  
BOTH SIDE LAMINATED DOORS



**EXTERNAL DOORS & WINDOWS**  
UPVC/ALUMINIUM POWDER COATED

## ELECTRICAL



**WIRING**  
COPPER ELECTRICAL WIRING  
THROUGHOUT IN CONCEALED  
CONDUIT FOR LIGHT POINTS



**SWITCHES / SOCKET**  
ISI MARKED SWITCHES  
& SOCKETS

## EXTERNAL DEVELOPMENT



**INTERNAL ROADS**  
INTERLOCKING BLOCKS/  
TREMIX CONCRETE ROAD



**BOUNDARY WALL**  
RCC / BRICK WALL  
WITH PLASTER &  
EXTERNAL WEATHER  
PROOF PAINT FINISH



**EXTERNAL PAINT**  
WEATHER PROOF TEXTURE  
PAINT IN BUILDINGS

## STRUCTURE



**EARTHQUAKE RESISTANT**  
RCC FRAMED STRUCTURE  
AS PER SEISMIC ZONE

## BEST BRANDS FOR THE BEST EXPERIENCE

|  |   |  |  |   |  |
|--|---|--|--|---|--|
| <p><b>TILES</b></p> <p>Kajaria<br/>VARMORA<br/>orientbell</p>  | <p><b>PAINTS</b></p> <p>asianpaints<br/>Dulux<br/>Berger</p>                                  | <p><b>DOOR LOCKS &amp; HANDLES</b></p> <p>dorsët<br/>quba<br/>IPSA</p>   | <p><b>GLASS</b></p> <p>SAINT-GOBAIN<br/>UPVC DOORS &amp; WINDOW PROFILES<br/>KÖMMERLING<br/>OKOTECH<br/>CP BATH FITTINGS</p> | <p><b>LIFTS</b></p> <p>OTIS<br/>KONE<br/>Schindler<br/>ELEVATORS BIRLA GROUP<br/>FUJITEC<br/>thyssenkrupp</p> | <p><b>PLUMBING PIPES</b></p> <p>Supreme<br/>ashirvad<br/>BIRLA HIL<br/>PIPES<br/>LIGHTING<br/>wipro<br/>OSRAM<br/>LEDVANCE<br/>SYSKA<br/>BAJAJ</p> |
| <p><b>SWITCHES</b></p> <p>legrand<br/>Crabtree<br/>wipro<br/>NORTH-WEST SANITARY FITTINGS<br/>hindware<br/>Jaquar<br/>KOHLER</p> | <p><b>WOODEN DOORS</b></p> <p>Bhutan tuff<br/>PAMA<br/>KITCHEN SINK<br/>CARYSIL<br/>Jayna</p> | <p><b>WIRES &amp; CABLES</b></p> <p>Finolex<br/>HAVELLS<br/>POLYCARB</p> | <p><b>CP BATH FITTINGS</b></p> <p>hindware<br/>Jaquar<br/>Kerovit</p>  |   |  |

All products, names, logos, brands, trademarks are properties of their respective owners. Product of other companies may also be used. However, priority will be given to the aforesaid brands/companies.